

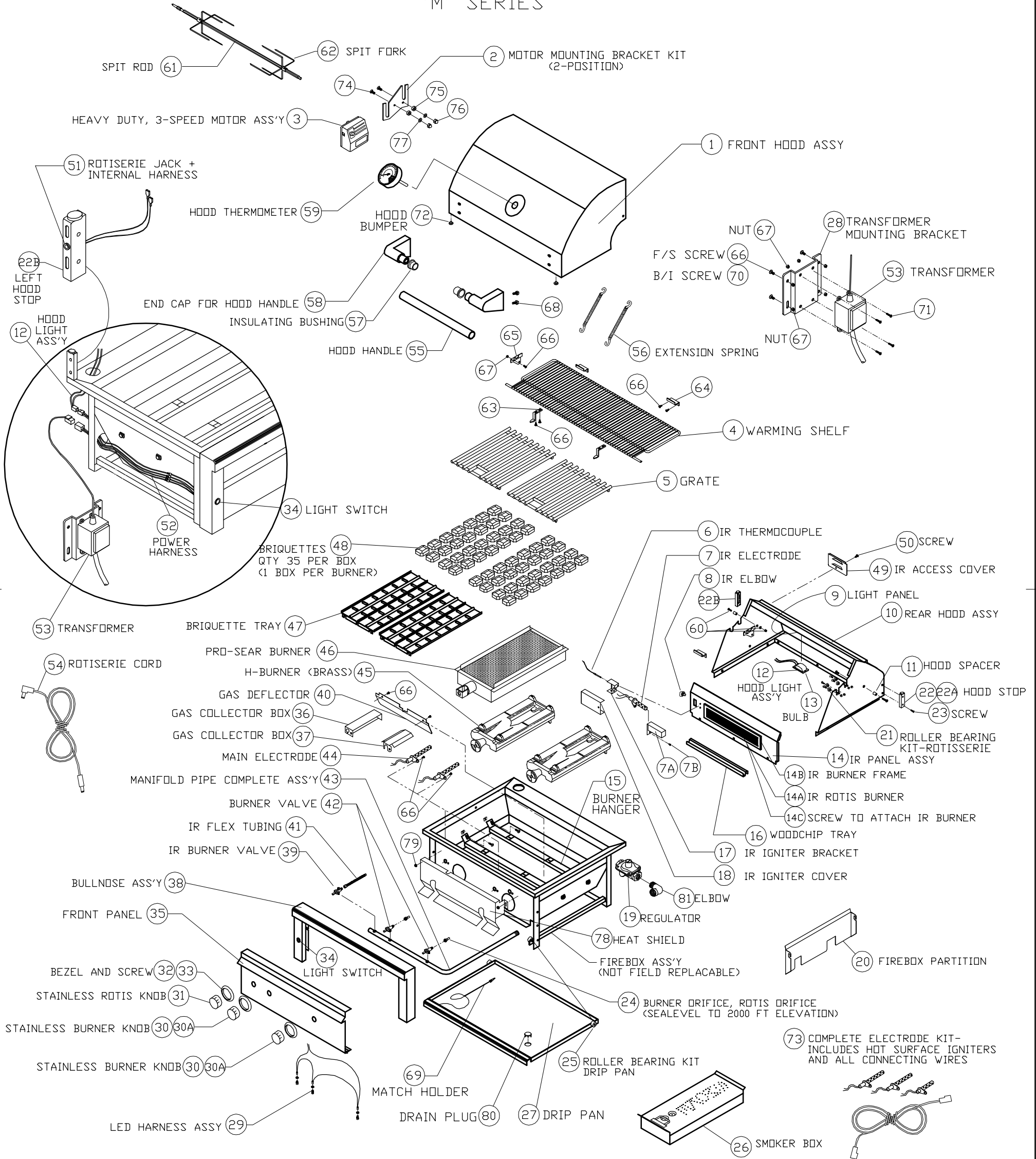

2011 PROFESSIONAL SERIES
'M' SERIES



2011 PROFESSIONAL SERIES PARTS LIST
'M' SERIES

ITEM	GRILL SIZE	PART NO.	DESCRIPTION	ITEM	GRILL SIZE	PART NO.	DESCRIPTION
1	L27	80322	FRONT HOOD ASSY, 27"	35	L27	80536	FRONT PANEL, PRO 27"
	L30	80309	FRONT HOOD ASSY, 30"		L27	80537	FRONT PANEL, NON-IR, PRO 27"
	L36	80310	FRONT HOOD ASSY, 36"		L30	80539	FRONT PANEL, 30"
	L42	80311	FRONT HOOD ASSY, 42"		L36	80538	FRONT PANEL, 36"
	L54	80312	FRONT HOOD ASSY, 54"		L42	80540	FRONT PANEL, 42"
2	ALL	90132	MOTOR MOUNTING BRACKET KIT, ALL PRO		L54	80541	FRONT PANEL, 54"
3	ALL	80277	MOTOR ASSY, HEAVY DUTY 3 SPEED	36	ALL	33058	GAS COLLECTOR BOX, H-BURNER
4	L27	32555	WARMING SHELF, PRO 27"	37	PS MODELS	33092	GAS COLLECTOR BOX, PROSEAR BURNER
	L30	32109	WARMING SHELF, PRO 30"	38	L27	80514	BULLNOSE ASS'Y, PRO 27"
	L36	32110	WARMING SHELF, PRO 36"		L30	80516	BULLNOSE ASS'Y, PRO 30"
	L42	32111	WARMING SHELF, PRO 42"		L36	80515	BULLNOSE ASS'Y, PRO 36"
	L54	32112	WARMING SHELF, PRO 54"		L42	80517	BULLNOSE ASS'Y, PRO 42"
5	L27	17012	(2) GRATES- 12" X 18"		L54	80518	BULLNOSE ASS'Y, PRO 54"
	L30	30018	(2) GRATES- 13 1/2" X 21"	39	ALL	31772	IR BURNER VALVE W/ MICROSWITCH
	L36	17020	(2) GRATES- 16 1/2" X 18 1/2"	40	L27 P/S	33451	GAS DEFLECTOR, 27" PROSEAR
	L42	30018	(2) GRATES- 13 1/2" X 21"		L30 P/S	33131	GAS DEFLECTOR, 30" PROSEAR
	L42	30019	(1) GRATE- 12" X 21" (CENTER)		L36 P/S	33132	GAS DEFLECTOR, 36" PROSEAR
	L54	30018	(2) GRATES- 13 1/2" X 21"		L42 P/S	33133	GAS DEFLECTOR, 42" PROSEAR
	L54	30019	(2) GRATES- 12" X 21"		L54	33134	GAS DEFLECTOR, PRO 54" (PROSEAR)
6	ALL	20018	IR THERMOCOUPLE	41	ALL	31794	FLEX HOSE, 9 MM X 38" W/ 7/16 FITTINGS
7	ALL	33052	IR ELECTRODE, HOT SURFACE (SEE ALSO #73)	42	ALL	33339	MAIN BURNER VALVE W/ MICROSWITCH
7A	ALL	33093	GAS COLLECTOR BOX, IR ROTIS.		ALL	32845	MICROSWITCH REPLACEMENT FOR VALVE
	L54	33102	GAS COLLECTOR BOX, IR ROTIS. R/H 54"	43	L27	80251	MANIFOLD ASS'Y W/VALVES, 27" LP
7B	ALL	14018	SCREW, #6-32 X 1/4 PH. PAN HD		L27	80252	MANIFOLD ASS'Y W/VALVES, 27" LP NON IR
8	ALL	31795	IR BRASS ELBOW, 7/16-20 MALE THREAD		L27	80253	MANIFOLD ASS'Y W/VALVES, 27" NG
9	L27	32551	LIGHT PANEL/REAR HOOD LINER, 27"		L27	80254	MANIFOLD ASS'Y W/VALVES, 27" NG NON IR
	L30	32156	LIGHT PANEL/REAR HOOD LINER, 30"		L27	80429	MANIFOLD ASS'Y W/VALVES, 27" LP PROSEAR
	L36	32441	LIGHT PANEL FOR DUAL LIGHTS, 36"		L27	80428	MANIFOLD ASS'Y W/VALVES, 27" NG PROSEAR
	L42	32442	LIGHT PANEL FOR DUAL LIGHTS, 42"		L30	80211	MANIFOLD ASS'Y W/VALVES, 30" LP PROSEAR
	L54	32159	LIGHT PANEL FOR DUAL LIGHTS, 54"		L30	80212	MANIFOLD ASS'Y W/VALVES, 30" LP
10	L27	80320	REAR HOOD ASSY, PRO 27"		L30	80213	MANIFOLD ASS'Y W/VALVES, 30" NG PROSEAR
	L27	80321	REAR HOOD ASSY, PRO 27" NON-IR		L30	80214	MANIFOLD ASS'Y W/VALVES, 30" NG
	L30	80269	REAR HOOD ASSY, PRO 30"		L36	80227	MANIFOLD ASS'Y W/VALVES, 36" LP PROSEAR
	L36	80270	REAR HOOD ASSY, PRO 36"		L36	80228	MANIFOLD ASS'Y W/VALVES, 36" LP
	L42	80271	REAR HOOD ASSY, PRO 42"		L36	80229	MANIFOLD ASS'Y W/VALVES, 36" NG PROSEAR
	L54	80272	REAR HOOD ASSY, PRO 54"		L36	80230	MANIFOLD ASS'Y W/VALVES, 36" NG
11	ALL	20054	HOOD SPACER, ALL PRO SERIES		L42	80201	MANIFOLD ASS'Y W/VALVES, 42" LP PROSEAR
12	27,30	80446	HOOD LIGHT ASS'Y, SINGLE W/10W BULB		L42	80202	MANIFOLD ASS'Y W/VALVES, 42" LP
	36,42,54	80447	HOOD LIGHT ASS'Y, DUAL W/10W BULB		L42	80203	MANIFOLD ASS'Y W/VALVES, 42" NG PROSEAR
13	ALL	31979	BULB, REPLACEMENT, 10W HALOGEN		L42	80204	MANIFOLD ASS'Y W/VALVES, 42" NG
	ALL	32322	GLASS REPLACEMENT COVER W/ CLIP		L54	80220	MANIFOLD ASS'Y W/VALVES, 54" LP PROSEAR
14	L27	80318	IR PANEL ASSY, PRO 27" (INCLUDES BURNER)		L54	80221	MANIFOLD ASS'Y W/VALVES, 54" NG PROSEAR
	27 NON-IR	80319	REAR FINISHING PANEL, NON-IR, PRO 27"	44	ALL	33051	ELECTRODE, MAIN BURNER, HOT SURFACE (SEE #73)
	L30	80273	IR PANEL ASSY, 30" (INCLUDES BURNER)	45	30,42,54	30485	H-BURNER (BRASS)
	L36	80274	IR PANEL ASSY, 36" (INCLUDES BURNER)		27,36	11012	H-BURNER (BRASS)
	L42	80275	IR PANEL ASSY, 42" (INCLUDES BURNER)	46	PS MODELS	33000	PROSEAR BURNER, 30", 42", 54"
	L54	80276	IR PANEL ASSY, 54" (INCLUDES BURNER)		30,42,54	32242	SCREEN REPLACEMENT, PROSEAR BURNER
14A	L27	32988	IR ROTIS. BURNER ONLY (SMALL-16 IN.)		PS MODELS	32915	PROSEAR BURNER, SHORT, 27"/36"
	30,36,54	32989	IR ROTIS. BURNER ONLY (MEDIUM-21 IN.)		27,36	32243	SCREEN REPLACEMENT, PROSEAR BURNER, 27/36"
	L42	32990	IR ROTIS. BURNER ONLY (LARGE-28 IN.)	47	30,42,54	80015	BRIQUETTE TRAY, 30", 42", 54"
14B	L27	32991	IR BURNER FRAME ONLY (SMALL-16 IN.)		30,42,54	80364	COMPLETE TRAY W/ BRIQUETTES & CLIPS
	30,36,54	32992	IR BURNER FRAME ONLY (MEDIUM-21 IN.)		42,54	80033	BRIQUETTE TRAY, NARROW, 42",54"
	L42	32993	IR BURNER FRAME ONLY (LARGE-28 IN.)		42,54	80365	COMPLETE TRAY W/ BRIQUETTES & CLIPS
14C	ALL	32644	SCREW, #8-32 X 5/16 PH. FLAT HD		27,36	80542	BRIQUETTE TRAY, 27", 36"
15	L27	10067	BURNER HANGER, PRO 27"		27,36	80543	COMPLETE TRAY W/ BRIQUETTES & CLIPS
	L30	32484	BURNER HANGER, PRO 30"	48	ALL	90053	BRIQUETTES, 35 PER BOX
	L36	32245	BURNER HANGER, PRO 36"	49	ALL	30417	IR ACCESS COVER
	L42	32485	BURNER HANGER, PRO 42"	50	ALL	14012	SCREW, 1/4-20 X 3/8 PH TRUSS HD, S/S
	L54	32486	BURNER HANGER, PRO 54"	51	ALL	80440	ROTISERIE JACK + INTERNAL HARNESS
16	27,30,54	10159	WOODCHIP TRAY (27", 30", 54")		ALL	33129	JACK ONLY, DC PANEL MOUNT
	36,42	10158	WOODCHIP TRAY (36", 42")	52	ALL	80533	MAIN POWER HARNESS (27IR, 30, 36, 42, 54)
17	ALL	33059	IR IGNITER BRACKET, PRO		L27 NON-IR	80534	MAIN POWER HARNESS, 27" NON-IR
	L54	33060	IR IGNITER BRACKET, RIGHT, 54"	53	ALL	33100	TRANSFORMER, 5 AMP, ALL PRO
18	L30	33135	IR IGNITER COVER, PRO 30"	54	ALL	33416	ROTISERIE EXTERNAL CORD
	27,36,42,54	33136	IR IGNITER COVER (27", 36", 42", 54")	55	L27	32557	HOOD HANDLE, 27"
19	ALL NG	30781	REGULATOR 4/11 N/G ONLY		L30	32522	HOOD HANDLE, 30"
	ALL LP	13053	REGULATOR W/30" HOSE DOUBLE STAGE-LP		L36	32523	HOOD HANDLE, 36"
20	30,42,54	32743	FIREBOX PARTITION, PROSEAR 30",42",54"		L42	32524	HOOD HANDLE, 42"
	27/36	33433	FIREBOX PARTITION, PROSEAR 27"/36"		L54	32525	HOOD HANDLE, 54"
21	ALL	90128	ROLLER BEARING KIT-ROTISSERIE (2 PARTS EA)	56	30,42,54	31874	EXTENSION SPRING, 30", 42", 54"
22	ALL	32468	HOOD STOP, RIGHT, ALL PRO		27,36	31780	EXTENSION SPRING, 27", 36"
22A	ALL	32470	BUMPER FOR HOOD STOP, .750 DIA	57	ALL	31738	INSULATING BUSHING, HOOD HANDLE
22B	ALL	33389	HOOD STOP, LEFT, ALL PRO	58	ALL	31736	END CAP FOR HOOD HANDLE
23	ALL	32469	SCREW/HOOD STOP-#8-32 X 1" PH TRUSS HD	59	ALL	31200	HOOD THERMOMETER
24	L27,L36	PRENGK	COMPLETE DRIFICE FIELD KIT-LP TO NG	60	ALL	14013	PIVOT SCREW, 1/4-20 X 1" HEX DRIVE
	L27,L36	PRELPK	COMPLETE DRIFICE FIELD KIT-NG TO LP		ALL	14009	PIVOT SCREW NUT, HEX, 1/4-20 S/S
	30,42,54	PRONGK	COMPLETE DRIFICE FIELD KIT-LP TO NG		ALL	14026	PIVOT WASHER, SPLIT LOCK, 1/4 S/S
	30,42,54	PRDLPK	COMPLETE DRIFICE FIELD KIT-NG TO LP	61	L27	32556	SPIT ROD, PRO 27"
	L27,L36	13013	DRIFICE,BURNER, NG (#41 SHORT)		L30	32128	SPIT ROD, PRO 30"
	L27,L36	13019	DRIFICE,BURNER, LP (#53 SHORT)		L36	32129	SPIT ROD, PRO 36"
	30,42,54	30329	DRIFICE,BURNER, NG (#41 LONG)		L42	32130	SPIT ROD, PRO 42"
	30,42,54	30328	DRIFICE,BURNER, LP (#53 LONG)		L54	32131	SPIT ROD, PRO 54"
	PROSEAR	13015	DRIFICE,BURNER, NG (#44 SHORT)	62	ALL	31563	SPIT FORK, HEAVY DUTY, ALL SIZES
	PROSEAR	13020	DRIFICE,BURNER, LP (#54 SHORT)	63	ALL	33033	FRONT RETAINING BKT., WARMING RACK
	30,36,54	13016	DRIFICE, IR ROTIS., NG (#50 SHORT)	64	ALL	32133	REAR RETAINING BRACKET, WARMING RACK
	30,36,54	13021	DRIFICE, IR ROTIS., LP (#57 SHORT)	65	ALL	32194	LEFT RETAINING BRACKET, WARMING RACK
	L27"	13016	DRIFICE, IR ROTIS., NG (#50 SHORT)	66	ALL	14014	SCREW #8-32 X 3/8 PH TRUSS HEAD S/S
	L27"	13021	DRIFICE, IR ROTIS., LP (#57 SHORT)	67	ALL	14024	LOCK NUT, #8-32, S/S
	L42"	30470	DRIFICE, IR ROTIS., NG (#48 SHORT)	68	ALL	31930	BOLT, HEX HEAD, 1/4-20 X 3/8", S/S
	L42"	31342	DRIFICE, IR ROTIS., LP (#56 SHORT)	69	ALL	31031	ALTERNATE LIGHTING DEVICE, MATCH HOLDER
25	ALL	90129	ROLLER BEARING KIT-DRIP PAN (2 PARTS EA)	70	ALL	31013	SCREW, #8 X 1/2 PH TRUSS HD TYPE 'A'
26	30,42,54	90073	SMOKER BOX ASSY 30", 42", 54"	71	ALL	31649	SCREW, #8-32 X 5/8 PH. PAN HD, S/S
	27,36	90074	SMOKER BOX ASSY, 27", 36"	72	ALL	32477	HOOD BUMPER, .500 DIA
27	L27	32548	DRIP PAN, PRO 27"	73	L27 NON-IR	90146	COMPLETE ELECTRODE KIT, 27" NON-IR
	L30	18050	DRIP PAN, PRO 30"		27,30	90147	COMPLETE ELECTRODE KIT, 27"IR/30"
	L36	31494	DRIP PAN, PRO 36"		36,42	90148	COMPLETE ELECTRODE KIT, 36"/42"
	L42	18051	DRIP PAN, PRO 42"		L54	90149	COMPLETE ELECTRODE KIT, 54"
	L54	31324	DRIP PAN, PRO 54"	74	ALL	14099	SCREW, #10-24 X 3/4 PH FLAT HD S/S
28	ALL	33130	TRANSFORMER MOUNTING BRKT B/I & F/S	75	ALL	32939	ROTIS. SPACER
29	27 NON-IR	80434	LED HARNESS ASSY, 27" NON-IR	76	ALL	32196	NUT, ACORN, #10-24, S/S
	27,30	80435	LED HARNESS ASSY, 27"IR/30"	77	ALL	32197	WASHER, #10 SPLIT LOCK, S/S
	36,42	80436	LED HARNESS ASSY, 36"/42"	78	L27	32596	HEAT SHIELD, PRO 27"
	L54	80437	LED HARNESS ASSY, 54"		L27	33061	HEAT SHIELD, PROSEAR 27"
	ALL	32554	LED HOLDER		L30	31669	HEAT SHIELD, PRO 30"
30	ALL	90137	KNOB, BURNER, STAINLESS		L30	31813	HEAT SHIELD, PROSEAR 30"
30A	ALL	90139	KNOB KIT, STAINLESS (3 BURNER+1 ROTIS)		L36	31815	HEAT SHIELD, PRO 36"
31	ALL	90136	KNOB, ROTIS, STAINLESS		L36	31816	HEAT SHIELD, PROSEAR 36"
32	ALL	10001	BEZEL		L42	31698	HEAT SHIELD, PRO 42"
33	ALL	31929	BEZEL SCREW, #6-32 X 1/8 PH PAN		L42	31817	HEAT SHIELD, PROSEAR 42"
34	ALL	33148	LIGHT SWITCH + HARNESS, BLUE LIGHTED		L54	32275	HEAT SHIELD, PROSEAR 54"
				79	ALL	14023	NUT, COMBINATION (FOR HEAT SHIELD)
				80	ALL	90151	DRAIN PLUG AND SEAL KIT, DRIP PAN
				81	ALL NG	13010	ELBOW, STREET, 1/2" 90 DEGREE-NG ONLY
					ALL LP	13054	ELBOW, 3/8" FLARE TO 1/2" FIP-LP ONLY